

1310nm and 1550nm

Product Description

The MicroMini isolators incorporate highly efficient optical components into a micro-miniature package.

ISOWAVE's double isolator offers the highest peak isolation available and includes the same polarization axis for input and out-put light.

ISOWAVE's semi-double isolator includes one polarizer between two Faraday rotators, offering superior isolation over wide ranges of temperature and wavelength.

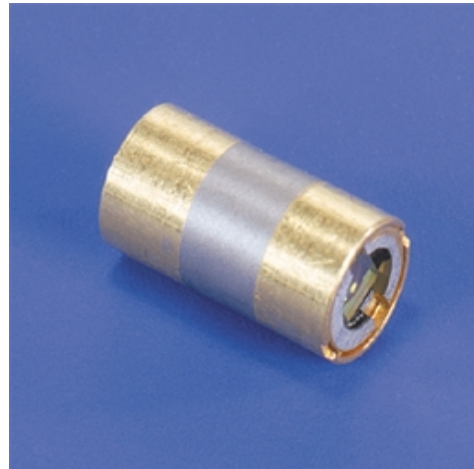

Applications

- Semiconductor Laser Modules
- Tunable Laser Modules
- Small Form Factor Laser Modules

Features

- Low Insertion Loss
- High Isolation
- Micro-Miniature Size
- Broad Bandwidth
- Wide temperature range
- Polaziation alignment

OUTLINE DRAWING

Model # I-15-MM-SD-4

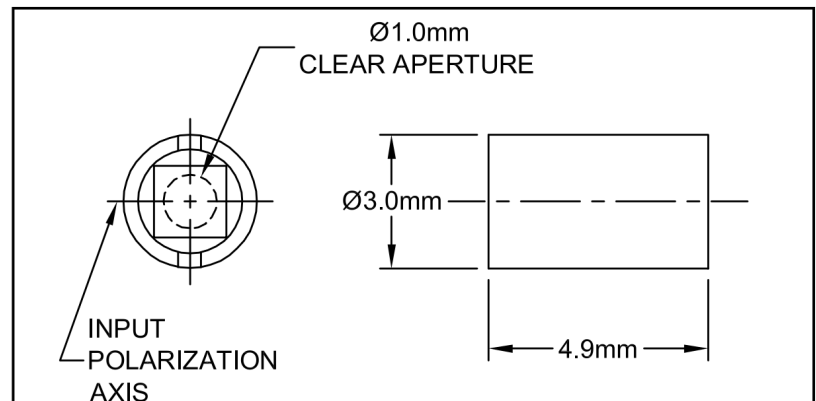

| | MM | LM | MM-SD | LM-SD | MM-TD | LM-TD |
|--|-------------------------|-----|-------------|-------|----------|-------|
| Wavelength | 1310nm | | 1310nm | | 1310nm | |
| | 1550nm | | 1550nm | | 1550nm | |
| Isolation at 23°C | ≥ 38dB | | ≥ 55dB | | ≥ 63dB | |
| Isolation ± 20nm and over operating temperatures | ≥ 20dB | | ≥ 45dB | | ≥ 45dB | |
| Insertion Loss (typical) | ≤ 0.2dB | | ≤ 0.4dB | | ≤ 0.5dB | |
| Insertion Loss Over Wavelength | ≤ 0.4dB | | ≤ 0.6dB | | ≤ 0.7dB | |
| Clear Aperature (mm) | 1.0 | 1.4 | 1.0 | 1.4 | 1.0 | 1.4 |
| Bandwidth | ± 20nm | | | | | |
| Diameter (nominal) (mm) | 3 | 4 | 3 | 4 | 3 | 4 |
| Component Tilt Option | 0° or 4° (as specified) | | | | | |
| Length: | | | | | | |
| 0° tilt | ≤ 2.5mm | | ≤ 4.7mm | | ≤ 6.75mm | |
| 4° | ≤ 3.0mm | | ≤ 5.0mm | | ≤ 7.0mm | |
| Operating Temperature | -20° to +70°C | | 0° to +70°C | | | |
| Storage Temperature | -40° to +85°C | | | | | |
| For custom configurations or specifications, please contact an ISOWAVE sales engineer. | | | | | | |

THEORETICAL ISOLATION CURVE

Model # I-15-MM-SD-4

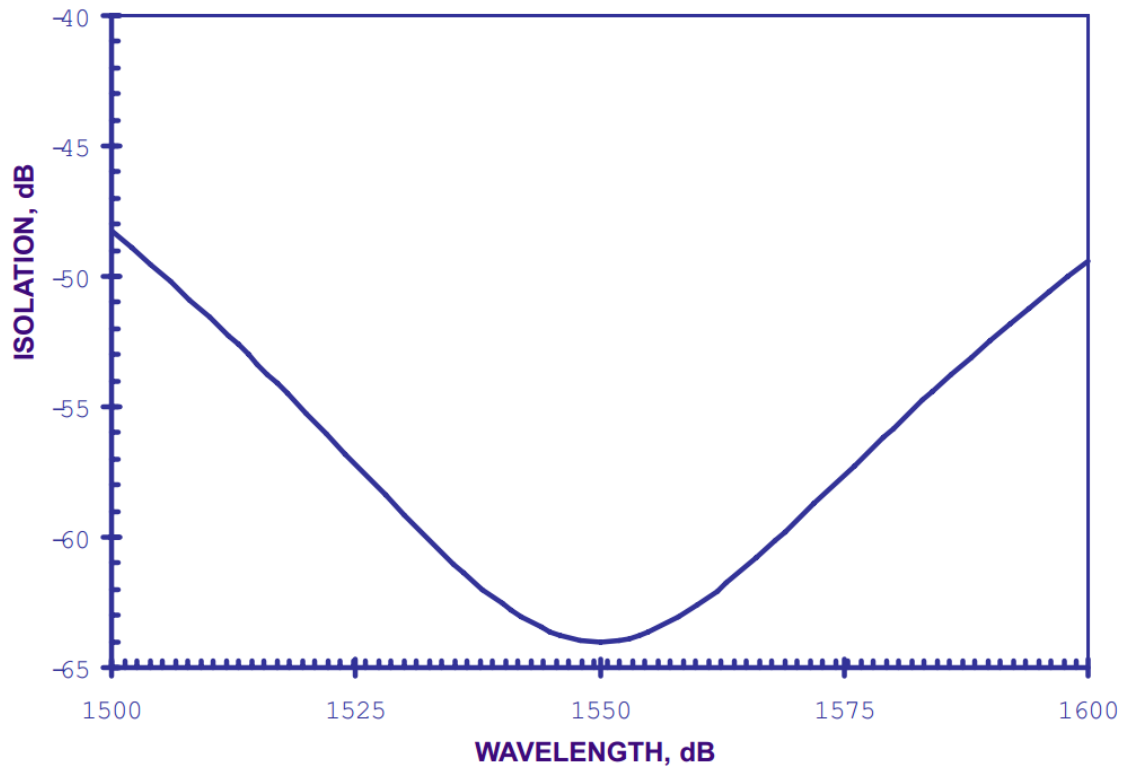

ORDERING INFORMATION

